

PARTS IDENTIFICATION

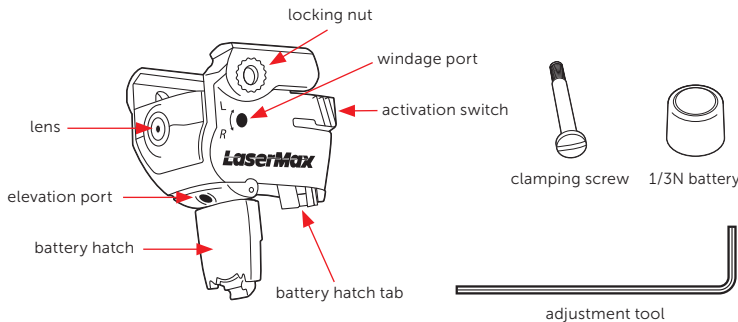

REPLACEMENT PARTS

04816-A-1	adjustment tool
LMS-13N	replacement battery
LMS-2x13N	2-pack replacement 3V batteries
06391-0-1	clamping screw

! IMPORTANT: PRIOR TO INSTALLATION, BATTERY CHANGE, CLEANING OR MAINTENANCE, FOLLOW THE FIREARM OPERATOR'S MANUAL TO ENSURE THAT THE FIREARM IS UNLOADED.

INSTALLATION

- To remove laser from package use a flat head screwdriver (not supplied) to unscrew clamping screw from right side of laser housing.
- Position Micro II on firearm rail.
- Guide Micro II into position, aligning clamping screw hole with preferred notch on rail (see figure 1).
- Insert clamping screw into right side of laser housing (see figure 2). When fully inserted, clamping screw will engage locking nut.
- Tighten clamping screw with a flat head screwdriver (not supplied).

Note: Variations in depth of handgun rail notches may require that clamping screw be pressed from locking nut end to remove.

OPERATING INSTRUCTIONS

- To turn the laser on, press and release the activation switch from either side (see figure 3). Press and release again to turn the laser off.
- To switch the laser aiming point from pulse to steady, turn the laser on, then press and hold the activation switch for 3 seconds. Press and hold the activation switch for 3 seconds again to return to the previous mode.
- To save power and prevent inadvertent battery drain, Micro II will shut off automatically after a ten minute period of inactivity. Cycle the activation switch to turn the laser back on.

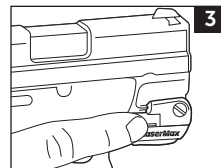
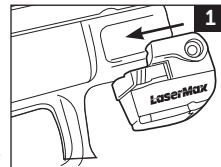

ALIGNING THE LASER

- Alignment adjustments should be made at a minimum of 10 yards from the target. To begin, insert the adjustment tool into one of the two alignment ports (figures 4 & 5) and slowly rotate the tool while comparing the laser position on target to the fixed sights.
- Important:** Do not turn alignment screws more than one full turn in either direction from their factory position. This may cause damage to the laser and void the warranty. A one quarter turn will result in a movement of about 7 inches at 10 yards.
- Windage adjustment:** with the muzzle pointing forward and adjustment tool inserted into the alignment port on the right side, a clockwise turn will shift the laser aiming point to the left and a counterclockwise turn will shift the laser beam to the right.
- Elevation adjustment:** with the muzzle pointing forward and adjustment tool inserted into the alignment port on the bottom, a clockwise turn will shift the laser beam down and a counterclockwise turn will shift the laser beam up.

Note: a slight shift in alignment may be observed after firing Micro II for the first time. Recheck alignment after break in and readjust as necessary.

BATTERY REPLACEMENT

Micro II can remain on the firearm or be removed to change the battery.

- Keep firearm pointed in a safe direction.
- Press and hold battery hatch near tab (see figure 6). While maintaining pressure on battery hatch with one hand, use

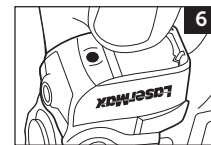
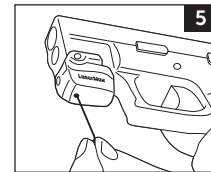
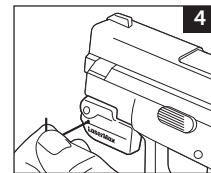

- the other hand to press battery hatch tab away from battery hatch (see figure 7).
- Release battery hatch to expose battery chamber.
- Replace expended battery with fresh 1/3N battery. The flat, inscribed side of battery should face outward (see figure 8).
- Secure battery hatch by applying gentle pressure until it snaps closed.

- Remove and immediately recycle or dispose of used batteries according to local regulations and keep away from children. Do NOT dispose of batteries in household trash or incinerate.
- Even used batteries may cause severe injury or death. Call a local poison control center for treatment information.
- Non-rechargeable batteries are not to be recharged.
- Do not force discharge, recharge, disassemble, heat above 140°F or incinerate. Doing so may result in injury due to venting, leakage, or explosion resulting in chemical burns.
- Ensure the batteries are installed correctly according to polarity (+ and -).
- Do not mix old and new batteries, different brands or types of batteries, such as alkaline, carbon-zinc, or rechargeable batteries.
- Remove and immediately recycle or dispose of batteries from equipment not used for an extended period of time according to local regulations.
- Always completely secure the battery compartment. If the battery compartment does not close securely, stop using the product, remove the batteries, and keep them away from children.

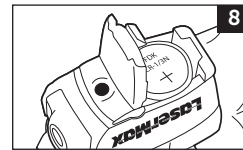
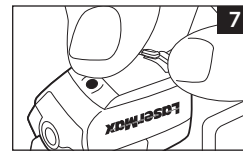

⚠️ WARNING



- **INGESTION HAZARD:** This product contains a button cell or coin battery.
- **DEATH** or serious injury can occur if ingested.
- A swallowed button or coin battery can cause **Internal Chemical Burns** in as little as **2 hours**.
- **KEEP** new and used batteries **OUT OF REACH OF CHILDREN**
- **Seek immediate medical attention** if a battery is suspected to be swallowed or inserted inside any part of the body.

⚠️ WARNING: THIS PRODUCT CAN EXPOSE YOU TO LEAD, WHICH IS KNOWN TO THE STATE OF CALIFORNIA TO CAUSE CANCER, AND BIRTH DEFECTS OR OTHER REPRODUCTIVE HARM. FOR MORE INFORMATION GO TO WWW.P65WARNINGS.CA.GOV.

CLEANING

After repeated fire, the lens may become clouded with gunpowder residue. For best results, it is recommended that this area be cleaned, along with the firearm, after each use.

To clean the lens, follow these steps:

1. Keep firearm pointed in a safe direction.
2. Confirm laser is off.
3. Dampen the end of a cotton swab with isopropyl alcohol.
4. Apply dampened swab to lens and polish in a small circular pattern. Be sure to clean around edges of lens.

WARNING

Firearm should be cleaned and lubricated exactly as directed in the Owner's Manual. Excess lubricant can interfere with the proper function of both the firearm and the Micro II Laser. LaserMax components should never be submerged or flushed with cleaning solvents. Failure to adhere to these guidelines may cause damage and void the factory warranty.

LASERMAX LIMITED WARRANTY

LaserMax is pleased to offer a five (5) year limited warranty for this product. To take advantage of this coverage, the product must be registered no later than 90 days after purchase.

This product may be registered by completing a Registration Form which may be found at www.lasermax.com/support or by contacting the LaserMax Customer Service Department at 1-800-527-3703. The LaserMax Limited Warranty extends specific legal rights to the registrant. Other rights, which vary from state to state, may also apply. This product is warranted to be free from defects in material and workmanship at the time of purchase. This limited warranty does not cover expendable parts (ex: batteries), that have definite and predictable life expectancies. This warranty does not cover products that LaserMax determines have been exposed to abnormal use in any way. Examples of abnormal use include, but are not limited to, damage from mishandling, misuse or abuse, damage from exposure to abnormal conditions, damage from improper care and maintenance, or installation of the product in or on any firearm model the product is not specifically advertised to be used with. Warranty coverage begins on the date of purchase and ends five (5) years after date of purchase. This limited warranty extends only to the original registrant and is non-transferable. To file a warranty claim, a warranty repair request must be submitted, and a Return Merchandise Authorization (RMA) number issued by the LaserMax Warranty Department, within five (5) years from date of purchase. Following submission of a warranty claim, LaserMax reserves the right to inspect the product to determine its eligibility for warranty coverage. If deemed eligible, LaserMax will repair or replace the part(s)/product that LaserMax, at its sole discretion, determines to be defective during the warranty period. If deemed ineligible, LaserMax will return the part(s)/product with an explanation of why coverage is not available. LaserMax reserves the right to replace defective part(s)/product with an equivalent substitute product at its sole discretion. Any and all implied warranties, including the implied warranties of merchantability, fitness for a particular purpose, and non-infringement, also begin on the date of purchase and end five (5) years after date of purchase. This limitation does not apply to residents of states that disallow limitations on the length of implied warranties. The preceding process is both the exclusive remedy and LaserMax's exclusive liability for any warranty claim. **LASERMAX WILL NOT, UNDER ANY CIRCUMSTANCES, BE LIABLE FOR ANY INCIDENTAL, INDIRECT, CONSEQUENTIAL, PUNITIVE OR EXEMPLARY DAMAGES (EVEN IF LASERMAX HAS BEEN NOTIFIED OF THE POSSIBILITY OF SUCH DAMAGES) RESULTING FROM OR RELATED TO A PRODUCT, INCLUDING, WITHOUT LIMITATION, ANY LOSS OF PROFIT, OPPORTUNITY, OR DAMAGES IN EXCESS OF THE PURCHASE PRICE OF THE WARRANTIED PRODUCT. THIS LIMITATION DOES NOT APPLY TO RESIDENTS OF STATES THAT DISALLOW LIMITATIONS ON INCIDENTAL OR CONSEQUENTIAL DAMAGES.**



IF YOU EXPERIENCE AN ISSUE WITH YOUR LASER PLEASE DO NOT RETURN IT TO THE STORE.

Contact LaserMax Customer Service: 800-527-3703

MICRO-2-R
Red Laser
CLASS 3R VISIBLE LASER
Output Power: <5mW
Wavelength: 650nm

MICRO-2-G
Green Laser
CLASS 3R VISIBLE LASER
Output Power: <5mW
Wavelength: 510-535nm

For patent information, please visit:
www.lasermax.com/patents
MICRO-2A515 08/24 - REV D

LaserMax Products
Rogers, AR 72756 USA
www.lasermax.com

MICRO-2A515-08-24

REMINDER
Aiming a laser beam at moving vehicles including boats, aircraft, trains, and construction equipment may be illegal. Check current applicable laws and follow them accordingly.

DANGER
Laser radiation is emitted from the front aperture of the laser when the switch is activated.

WARNING
Avoid direct eye exposure to beam. Do not point laser at anything you do not wish to destroy.

NOTICE:
The FDA requires the label supplied with your laser be affixed to the outside of the gun near the laser aperture.

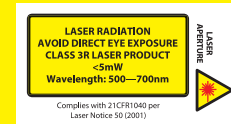

Copyright © 2024 Crosman Corporation. All rights reserved. LaserMax and the LaserMax logo are registered trademarks of Crosman Corporation. All other trademarks are property of their respective owners.

LaserMax

MICRO II
RAIL MOUNTED LASER SIGHT

OPERATOR'S MANUAL



MICRO-2-G
MICRO-2-R